



# Running IMF Tune with the Exchange 2007 Content Filter

# Agenda

- Content Filter Agent Installation
- Configuring Filter Thresholds
- Enabling the Junk Email Folder
- Installing IMF Tune v4 on Exchange 2007

# Content Filter Agent Installation

- A transport agent that runs on the Edge or Hub server roles
- Installed automatically with:
  - Exchange 2007 Edge Server Role
  - Small Business Server 2008 Exchange Hub transport
- Installed manually on Exchange 2007 Hub Transport using: `Install-AntiSpamAgents.ps1`

# Configuring Filter Thresholds

- Three Gateway Blocking Thresholds to Delete, Reject or Quarantine emails
- Gateway Blocking should be disabled when using IMF Tune
- One Threshold for moving emails to Junk configurable through the shell:  
Set-OrganizationConfig -SCLJunkThreshold <threshold level>

# Enabling Junk Email Folder

- Each mailbox has its own Junk Folder Enablement switch
- If using MS Outlook 2003 or later, the Junk Folder is automatically enabled on opening the mailbox for the first time
- To Enable/Disable Junk manually:
  - Log onto OWA and select: Options | Junk Email | Automatically Filter Junk Email
  - Or use this script: <http://gsexdev.blogspot.com/2007/07/turning-on-filter-junk-email-in.html>

# Installing IMF Tunev4

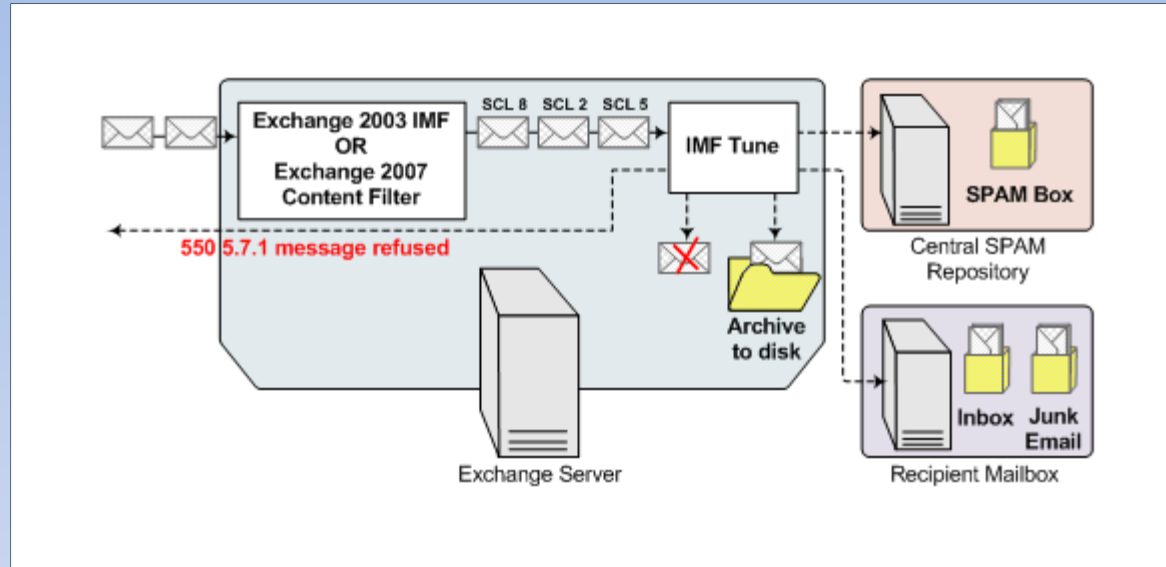

- Exchange 2007 requires IMF Tune v4 or later.
- Processes emails immediately after the Content Filter

# Installing IMF Tunev4 (contd.)

- Content Filter Gateway blocking should be disabled.
- Leaving Gateway blocking to IMF Tune allows:
  - Centralized configuration
  - More consistent reporting
  - Archiving of emails (even if rejected)
  - Applying of more powerful filtering rules giving better filtering results

# Links

IMF Tune Homepage/Download:

<http://www.windeveloper.com/imftune/>

IMF Tune Video Tutorials:

<http://www.windeveloper.com/imftune/tutor/>

Sales/Licensing:

[sales@windeveloper.com](mailto:sales@windeveloper.com)

Technical Support:

[support@windeveloper.com](mailto:support@windeveloper.com)